

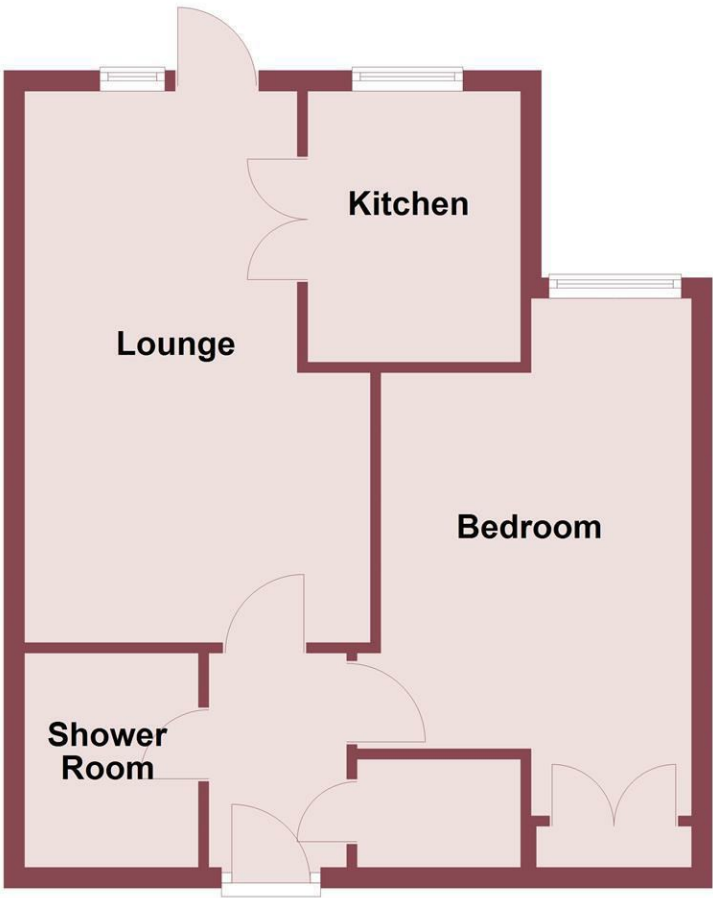

Ground Floor



Telegraph Road, Wirral, CH60 0AR  
Offers In The Region Of £135,000

 1 Bedroom  1 Reception  1 Bathroom 

**\*\*Ground Floor & Garden View - 1 Bedroom Apartment - No Chain - Over 65s - Must View\*\***

Hewitt Adams is delighted to offer to the market this GROUND-FLOOR retirement apartment in the POPULAR Beacon Court Development in the CENTRE OF HESWALL. Conveniently placed for EASY ACCESS to the wealth of amenities that Heswall has to offer.

These GROUND-FLOOR units INFREQUENTLY COME TO THE MARKET and are very, very SOUGHT AFTER. Even rarer still are the units that enjoy the GARDEN VIEW and do not overlook the car park, so the agents expect this to be very desirable.

In brief the accommodation affords: hall, lounge, kitchen, modern shower-room and a double bedroom. With a PLEASANT VIEW over communal gardens.

Beacon Court is a well designed and maintained building with security intercom, secured access and an on-site Day Manager who is responsible for the day to day running of the building. The apartments are equipped with 'Pull Cord Alert Systems' affording residents the security measures you would expect in a property of this type, and there are also communal washing machine facilities. Call Hewitt Adams on 0151 342 8200 to view.



Front Entrance

Into:

Hall

Door to storage cupboard

Lounge

17'6" x 11'0" (5.35 x 3.36)

Electric fire, power points, electric radiator, double glazed window and door with electric blinds, opens to:

Kitchen

8'11" x 5'8" (2.73 x 1.75)

Wall and base units, integrated oven and electric hob, space for fridge, space for freezer, double glazed window

Bedroom

18'1" x 8'9" (5.52 x 2.69)

Electric radiator, power point, double glazed window with electric blinds, integrated wardrobe

Shower Room

6'9" x 5'6" (2.08 x 1.69)

Comprising large shower, w.c, wash hand basin, tiled walls, heated towel rail

Additional Information

Service / maintenance charges - £3427.98

